

PILASTRATA 29

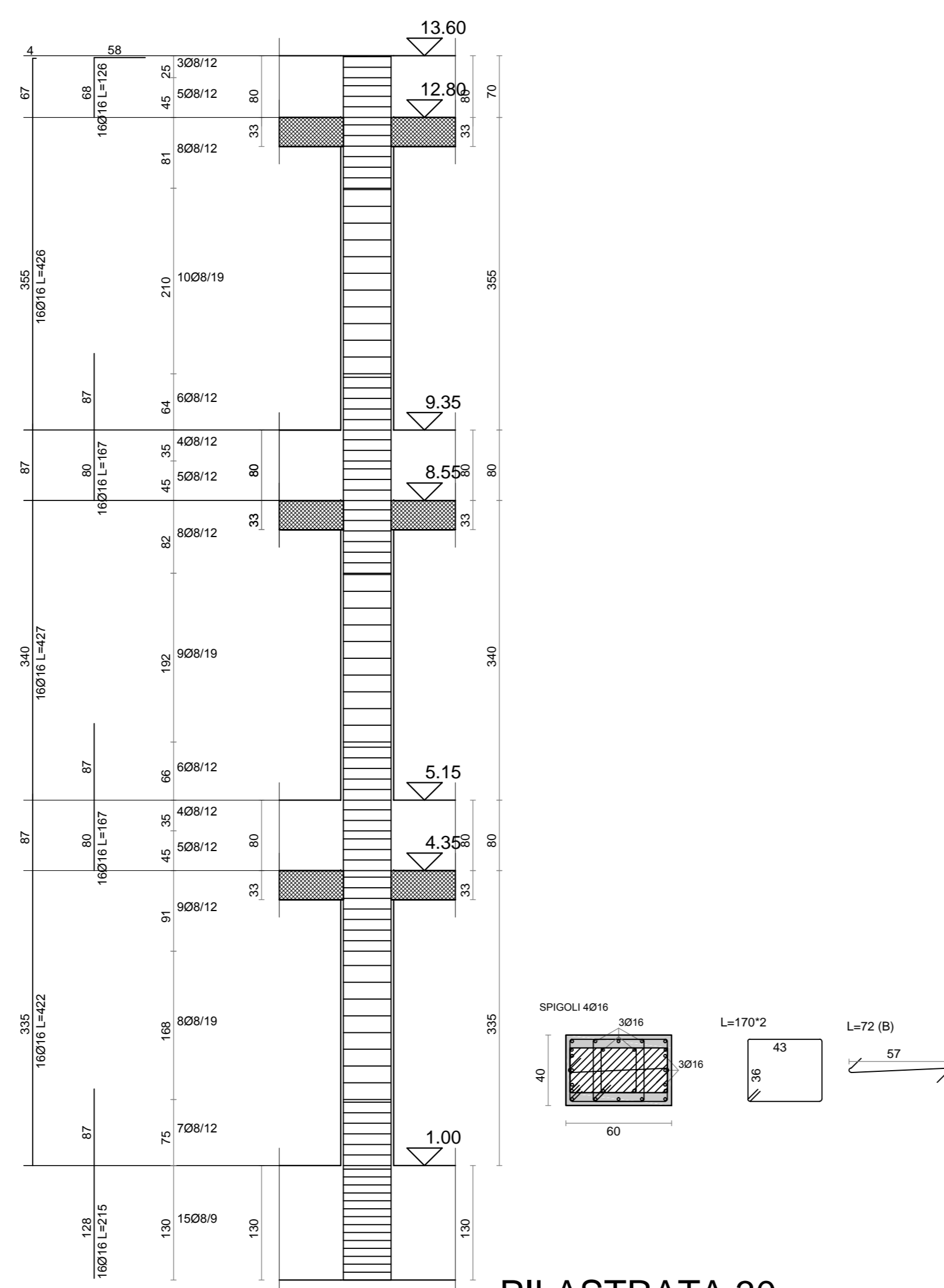

PILASTRATA 30

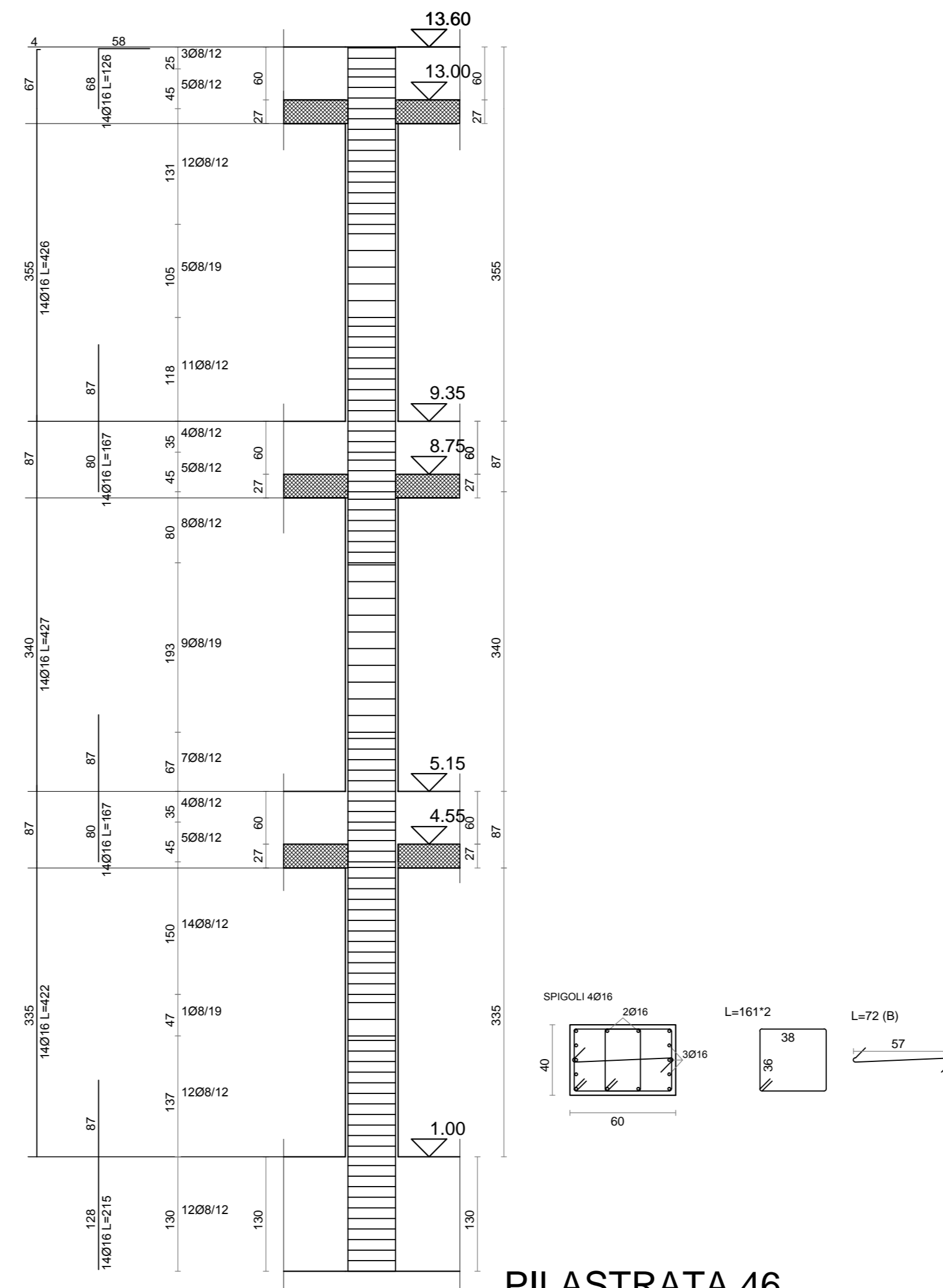

PILASTRATA 46

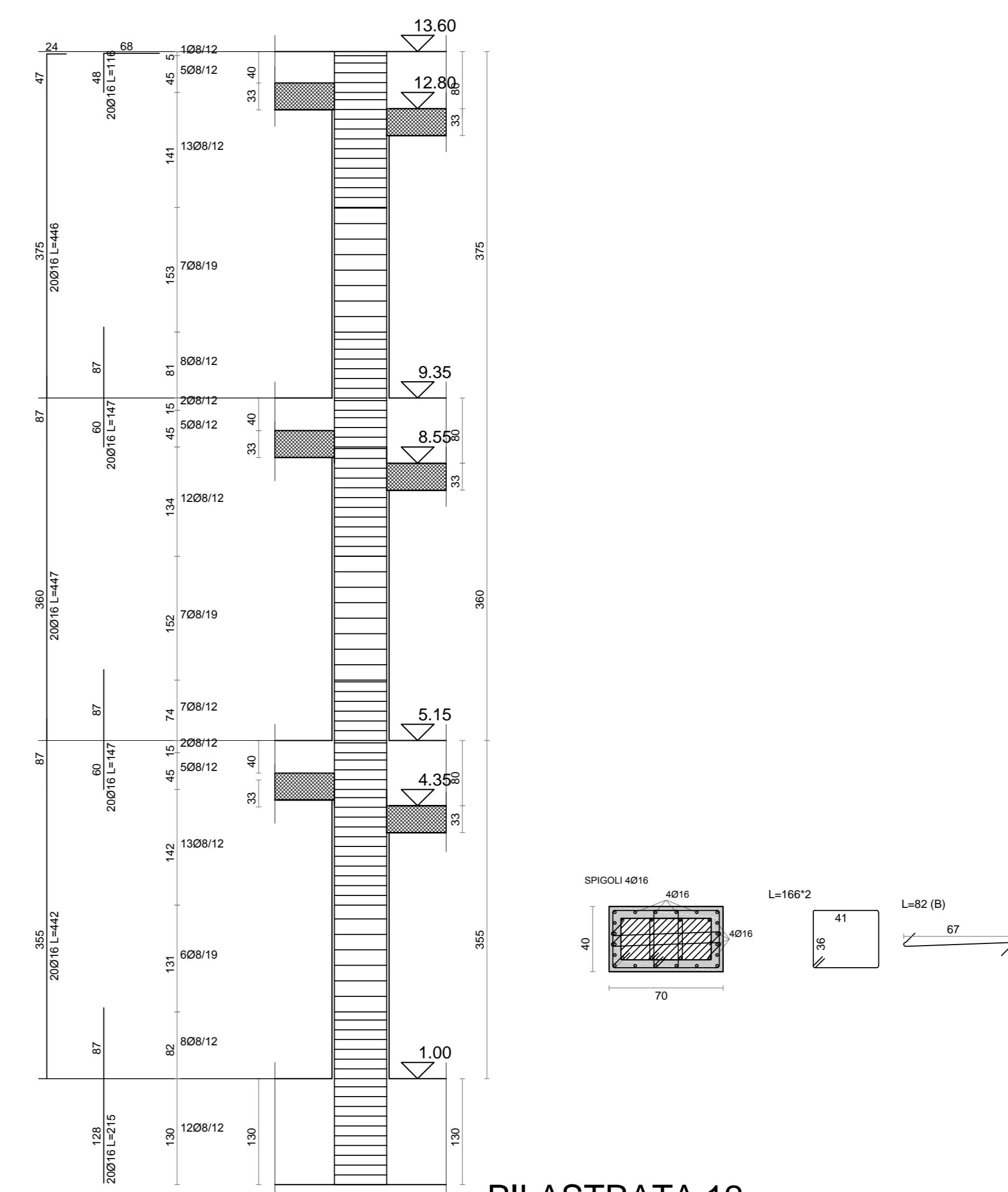

PILASTRATA 12

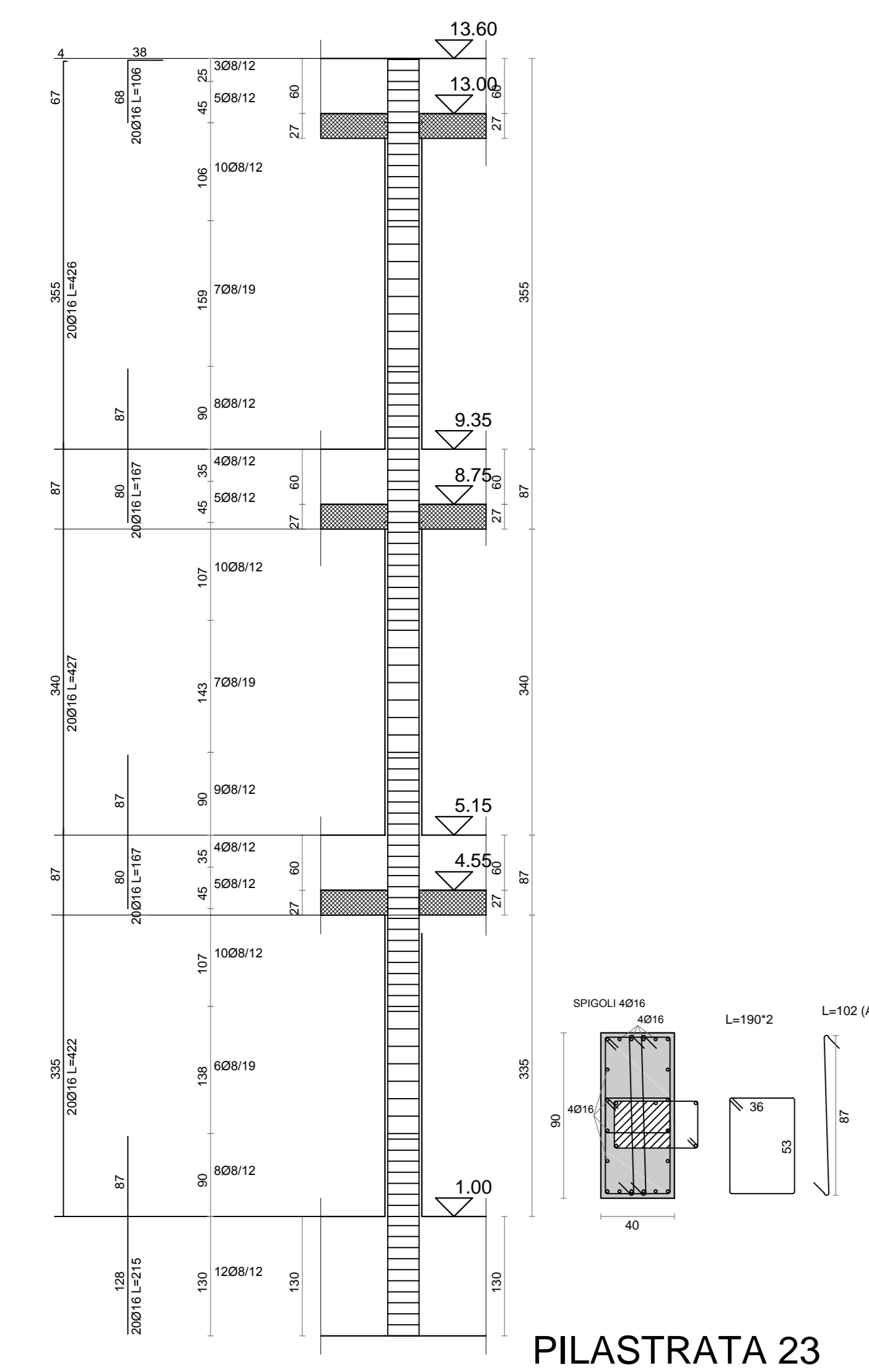

PILASTRATA 23

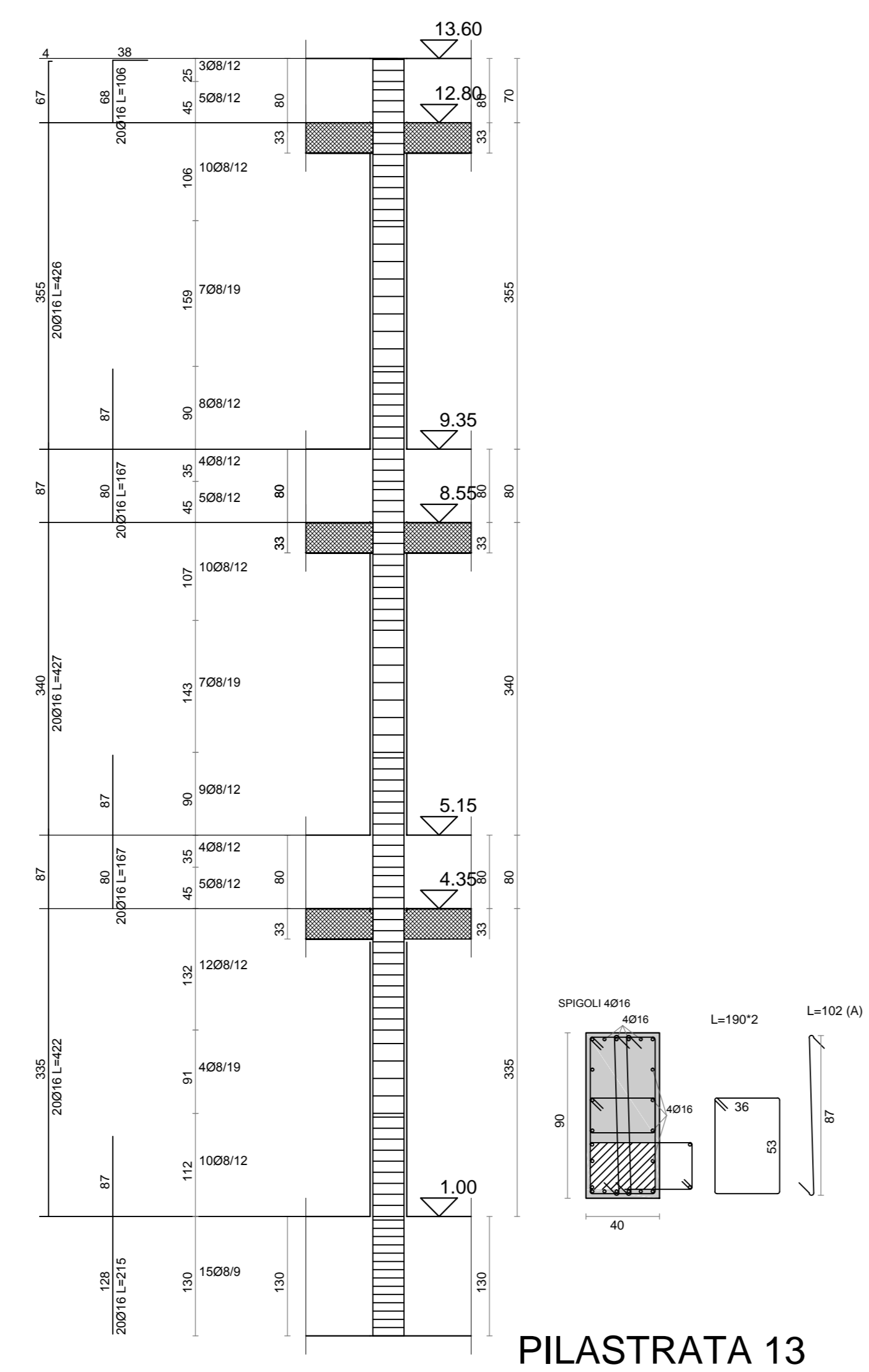

PILASTRATA 13

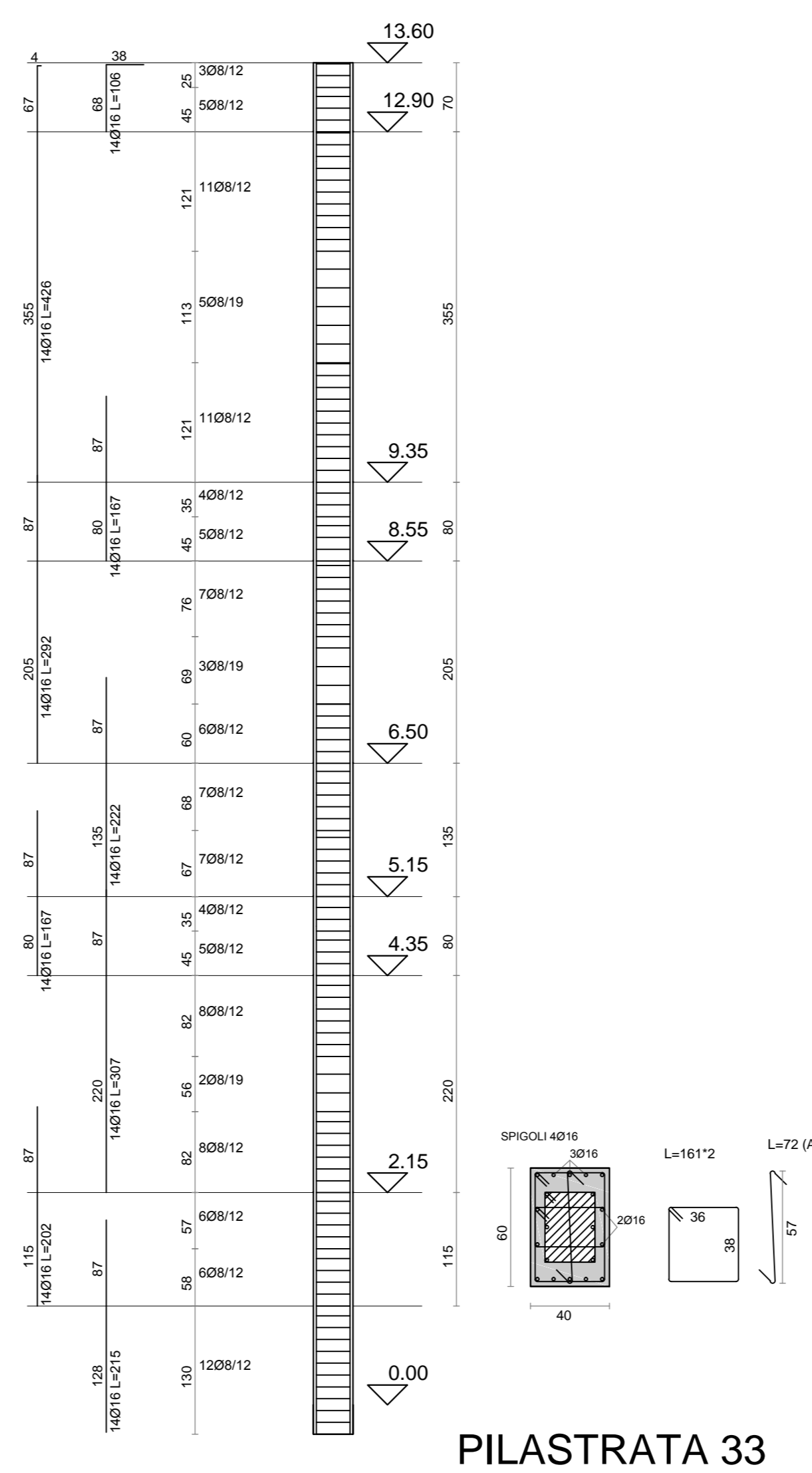

PILASTRATA 33

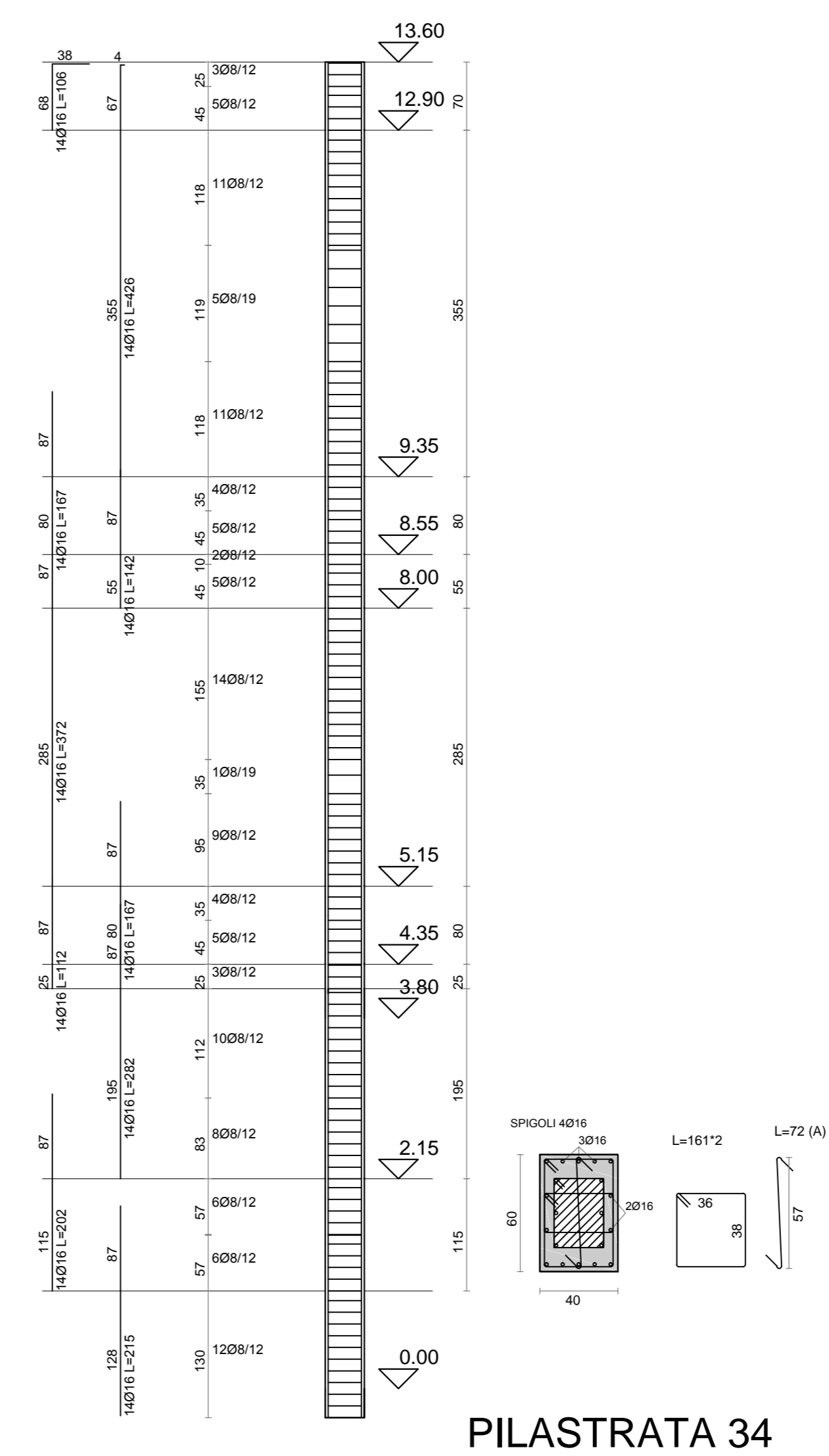

PILASTRATA 34

Ufficio tecnico Comunale - Settore LL.PP.



LAVORI DI MESSA IN SICUREZZA DEL PLESSO DELLA
 SCUOLA ELEMENTARE E MEDIA "F. CRISPI" DI PALAZZO ADRIANO PALERMO
 (PA)
PROGETTO ESECUTIVO
 Redatto ai sensi dell'Art.33 D.P.R. n.207/2010

IL PROGETTISTA
 Università "Kore" di Enna
 Ing. Dario Ticali

IL R.U.P.
 Geom. Giuseppe Cuccia

IL SINDACO
 Ing. Carmelo Nicola Cuccia

Ing. Mario Denaro

Tav.B.10.7
 PROGETTO CORPO A1 - PILASTRATE 12-13-23-29-33-34-46